

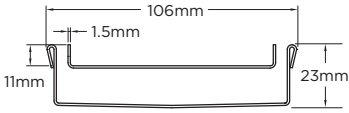

# Order and Quote Form

## Made-to-Length Tile Insert Drain

### Tray Profiles 100 Range



**Profile 1**

Suits tiles up to 10mm thick  
100Tii20MTL

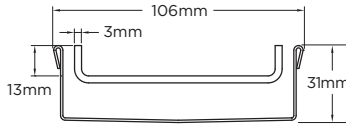

**Profile 2**

Suits tiles up to 12mm thick  
100Tii30MTL

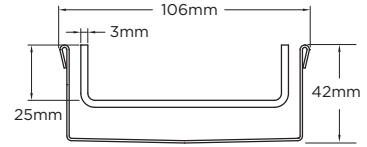

**Profile 3**

Suits tiles up to 25mm thick  
100Tii40MTL

### 65 Range

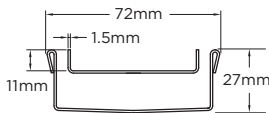

**Profile 4**

Suits tiles up to 10mm thick  
65Tii25MTL

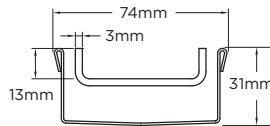

**Profile 5**

Suits tiles up to 12mm thick  
65Tii30MTL

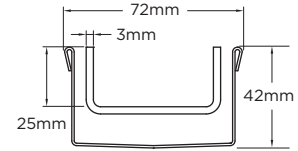

**Profile 6**

Suits tiles up to 25mm thick  
65Tii40MTL

### Specify Size, Outlet and Profile Required

#### Drain 1

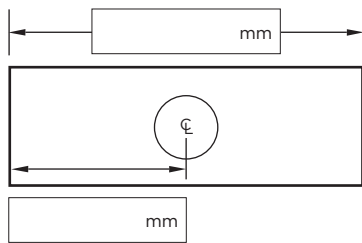

**Profile Required**

- 1    2    3  
 4    5    6

**Outlet Size**

- 38mm    44mm    51mm  
 63mm    76mm    89mm

#### Drain 2

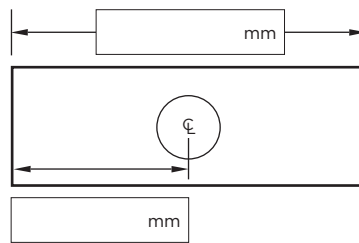

**Profile Required**

- 1    2    3  
 4    5    6

**Outlet Size**

- 38mm    44mm    51mm  
 63mm    76mm    89mm

#### Drain 3

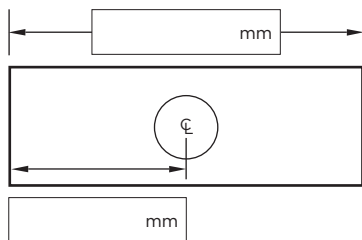

**Profile Required**

- 1    2    3  
 4    5    6

**Outlet Size**

- 38mm    44mm    51mm  
 63mm    76mm    89mm

#### Please Note

See AS3500 standard & local regulator for specific outlet/drain requirements.  
 Outlet Size must be smaller than selected Range.  
 Stainless Steel Grade is 316 unless specified.  
 Fast 3 day dispatch is for single outlet drains, no longer than 3000mm.  
 Fast 5 day dispatch for drains with multiple outlets or over 3000mm.  
 Made-to-Length (MTL) minimum charge of 800mm.  
 Orders received after 11am are processed as next working day.  
 Tile Inserts longer than 1200mm are supplied in multiple sections.  
 Channels are a maximum 3000mm in one piece, channels over 3000mm are supplied in multiple sections with joiner.  
 +/- 2mm tolerance on dimensions.

**Full Name**

**Company Name**

**Telephone**

**Email Address**

**Order Number**

**Stormtech Quote Number**

**Signature**